

REPORT AND NOTICE OF INSPECTION

532

TYPE CONTROL NO S9182		TYPE CHG 0 EXISTING 1 NEW		CLARK COUNTY HEALTH DISTRICT 625 SHADOW LANE • LAS VEGAS, NEVADA 89106				TELEPHONE 383-1271				
SAN DIST	LOCATION 21 8000 Lake Mead			CITY - TOWN Henderson								
CITY NAME	KERR-MCGEE CHEMICAL Corp			NOTE D-2 Bldg				TELEPHONE				
INFORMATION								SCHEDULED ACTION				
TYPE AND CATEGORY 080 081								ACTION	DATE			
								5	7-5-85			
PREVIOUS ACTION		VIOLATIONS - ALLEGED				VIOLATIONS - ACTUAL						
SAN C	ACTION	DATE	STATUS	SPECIAL DATE	VIOLATION							
CURRENT ACTION	SAN C	ACTION	DATE	STATUS	SPECIAL DATE	TIME IN	TIME OUT	T F I	MILES	FUTURE ACTION	ACTION	DATE
	17	5	7/8/85			10:00A	11:00A	24	23		2	7/8/85
NOTIFIED OF THE FOLLOWING												
REQUESTED FINAL INSPECTION OF LEACH FIELD ONLY. 840 SqFt												
<p>Const of Leach Area Approved - OK to backfill - Do NOT DRIVE over leach area</p>												
RECEIVED COPY	<i>Deann Murphy</i>				SANITARIAN	<i>J. Campbell</i>				REVIEWED BY	7-9-1985	

SEPTIC TANK:

Number of Compartments 2 Type of Material CONC
 Inside Dimension: Length 10 ft.; Width 5 ft.; Liquid Depth 3.5
 Total Liquid Capacity 1250 gal. Distance from Well _____ ft.

SUBSOIL DISPOSAL:

Distance from Well — ft. Distance from Foundation 50 ft.
 Distance from Nearest Lot Line 50 ft. at Front _____, Side , Rear _____

Seepage Beds:

Width 24 ft.; Length 40 ft.; Total Depth ft.
 Total effective absorption area in bottom of bed 960 sq. ft.
 Number of Lines 4 Length of each line 35 ft.
 Distance between lines 6 ft. Total length of tile lines 140 ft.
 Type of filter material: Gravel , Broken Stones _____, Other _____
 Depth of filter material beneath tile 1.6 ft. Over tile .16 ft.

Absorption Trenches:

Total length of tile lines _____ ft. Number of lines _____
 Length of each line _____ ft. Distance between lines _____ ft.
 Trench width _____ ft. Total effective absorption area on sides of trenches _____
 Depth of filter material beneath tile _____ ft.; Over tile _____ ft.

Seepage Pits:

Number of Pits _____ Diameter _____
 Effective Depth _____ ft. Lining Material _____
 Total effective absorption area of side wall _____

DATE OF APPROVAL: 7/8, 19 85

J. Campbell
Sanitarian

CLARK COUNTY HEALTH DISTRICT

Las Vegas, Nevada

PERMIT NUMBER 1 S 9 1 8 2				APPLICATION TO CONSTRUCT INDIVIDUAL SEWAGE DISPOSAL SYSTEM					
DISTRICT 21				TYPE CODE 080		CATEGORY 081		DATE 7-3-85	
BILLING CITY CODE 09				PROPERTY OWNER NAME KERR-McGee Chemical Corp					
APPLICANT NAME Pat Murphy				SUBDIVISION/PARCEL MAP NUMBER BMI					
PROPERTY LEGAL DESCRIPTION SW 1/4 Sec 12 T22S R62E				MINIMUM SEPTIC TANK SIZE 1000 Gal					
STREET NO. FRACTION DIRECTION 8000		STREET NAME Lake MEAD		MINIMUM LEACH FIELD SIZE 840 Sq Ft		TOTAL BEDROOMS/BATH n/a BDRMS 1 BATHS			
CITY Henderson				ZIP CODE		24 Chemical plant			
PHONE: PREFIX NUMBER EXTENSION		AREA CODE		25 WATER SUPPLY CONTROL NO					
SEPTIC TANK CONTRACTOR				26 PARCEL NUMBER 520 210 090					
WATER SUPPLIER BIM				27 PERMIT STATUS					
SANITATION DISTRICT VERIFICATION No sewer per BMI				28 EXPIRATION DATE					
APPLICANT/OWNER FREE FORM ADDRESS P M Mechanical Inc				29 RECEIPT NO. 04370					
STREET NO. FRACTION DIRECTION 2620		STREET NAME Western Ave		ZIP CODE 89109		30 PREPARED BY K Highley			
CITY Las Vegas		STATE Nv		31 APPROVED BY					
PHONE: AREA CODE PREFIX NUMBER EXTENSION 796 0966		IN THE SPACE PROVIDED BELOW, DRAW A LAYOUT OF YOUR PROPOSED SEWAGE DISPOSAL SYSTEM. INCLUDE ALL PROPERTY LINES, WATER COURSES, WELLS, BUILDINGS, SWIMMING POOLS, TREES, WATER LINES, STREAMS, AND EXACT DISTANCE IN FEET.							

16a FIXTURE UNITS:

FIXTURE	UNITS NO.	TOTAL
WATER CLOSETS	6 ea.	
BATHTUBS	2 ea.	
SHOWERS	2 ea.	
DOUBLE LAVATORIES	2 ea.	
SINGLE LAVATORIES	1 ea.	
KITCHEN SINK/ DISHWASHER	2 ea.	
CLOTHES WASHER	2 ea.	
OTHER:	ea.	
	ea.	

AN INDIVIDUAL SEWAGE DISPOSAL SYSTEM MAY SERVE ONLY ONE (1) SINGLE FAMILY DWELLING OR ONE (1) SINGLE BUILDING.

SEE ATTACHED PLOT PLAN

SEE ATTACHED FINAL INSTRUCTIONS

NO CHEMICAL WASTE TO ENTER SEPTIC SYSTEM. THIS INDUSTRIAL PERMIT IS ISSUED FOR TREATMENT OF HUMAN WASTE ONLY. ANY CHANGE IN DISCHARGE INTO THIS SEPTIC SYSTEM OR ANY TRANSFER OF THIS PROPERTY MUST HAVE THE APPROVAL OF CLARK COUNTY HEALTH DISTRICT FOR CONTINUED USE.

AREA MUST BE SECURED FROM VEHICULAR TRAFFIC.

PERMIT ISSUED TO PERMIT CONSTRUCTION OF NEW LEACH FIELD. OLD LEACH FIELD DAMAGED FROM VEHICULAR TRAFFIC.

LOCATION OF ISDS APPROVED BASED ON PLAT MAP PRESENTED BY APPLICANT THIS DATE AND SUBJECT TO RELEASE OF PATENT RIGHT OF WAY, IF ANY.

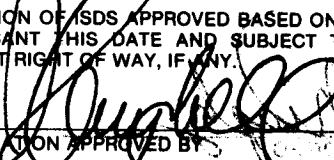
APPLICATION APPROVED BY:  WHITE - HEALTH DISTRICT

APPLICANTS SIGNATURE:  PINK - APPLICANT

EH 276 WHITE - HEALTH DISTRICT YELLOW - BUILDING DEPARTMENT PINK - APPLICANT

REPORT AND NOTICE OF INSPECTION

TYPE	CONTROL NO S9182	TYPE CHG 0 EXISTING 1 NEW	CLARK COUNTY HEALTH DISTRICT 625 SHADOW LANE • LAS VEGAS, NEVADA 89106				TELEPHONE 383-1271	6					
SAN	DIST 2	LOCATION 8000 Lake Mead Dr	CITY - TOWN Las Vegas										
CITY	NAME 09 KERR-MC GEE CHEMICAL CORP.	NOTE	(Richard Holmes) (Claude Cook Const)			TELEPHONE							
INFORMATION						SCHEDULED ACTION							
TYPE AND CATEGORY 080 081		CAPACITY				ACTION 5	DATE 6/22/79						
PREVIOUS ACTION		VIOLATIONS - ALLEGED		VIOLATIONS - ACTUAL									
SAN C	ACTION	DATE	STATUS	SPECIAL DATE	VIOLATION								
CURRENT ACTION	SAN C	ACTION	DATE	STATUS	SPECIAL DATE	TIME IN	TIME OUT	T F I	MILES	FUTURE ACTION	ACTION	DATE	
	34	5	6-22-79			12:00	1:00	12	6		2	6-22-79	
NOTIFIED OF THE FOLLOWING													
REQUESTED FINAL INSPECTION 1000 gal. 300 Sq. Ft. SW Sec 12 T22 R62 CHEMICAL PLANT Henderson Industrial Center													
<i>Installation approved</i>													
<i>Cover with untreated paper prior to backfill</i>													
RECEIVED COPY	<i>[Signature]</i>					SANITARIAN	<i>[Signature]</i>					REVIEWED BY	<i>[Signature]</i>
19													

SEPTIC TANK:

Number of Compartments _____ Type of Material _____
 Inside Dimension: Length 10'2" ft.; Width 5'2" ft.; Liquid Depth 3'5"
 Total Liquid Capacity 1250 gal. Distance from Well _____ ft.

SUBSOIL DISPOSAL:

Distance from Well BMT ft. Distance from Foundation 50 ft.
 Distance from Nearest Lot Line _____ ft. at Front _____, Side _____, Rear _____

Seepage Beds:

Width _____ ft.; Length _____ ft.; Total Depth ACREAGE ft.
 Total effective absorption area in bottom of bed 615 sq. ft.
 Number of Lines _____ Length of each line _____ ft.
 Distance between lines _____ ft. Total length of tile lines _____ ft.
 Type of filter material: Gravel _____, Broken Stones _____, Other _____
 Depth of filter material beneath tile _____ ft. Over tile _____ ft.

Absorption Trenches:

Total length of tile lines 150 ft. Number of lines 3
 Length of each line 50 ft. Distance between lines 6 ft.
 Trench width 2 ft. Total effective absorption area on sides of trenches 450
 Depth of filter material beneath tile 1.5 ft.; Over tile 6 ft.

Seepage Pits:

Number of Pits _____ Diameter _____
 Effective Depth _____ ft. Lining Material _____
 Total effective absorption area of side wall _____

DATE OF APPROVAL: 6-22, 1979

[Signature]
Sanitarian

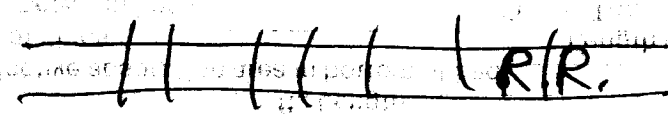
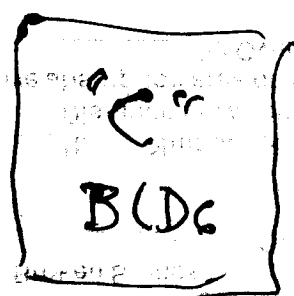
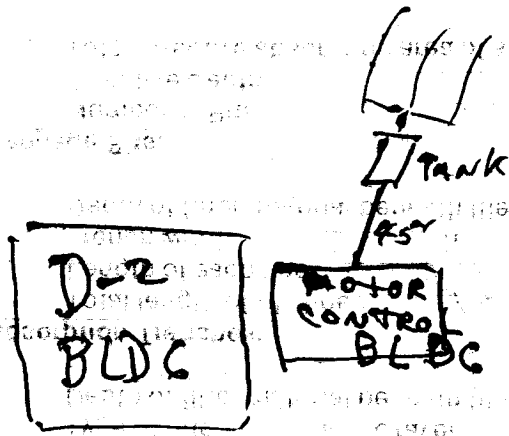

Just 6-22-79

CS

LAGOSIA JHSBUS

SEBUC 187K

[Handwritten signature]

APPLICATION TO CONSTRUCT INDIVIDUAL SEWAGE DISPOSAL SYSTEM

PERMIT NUMBER
 1 **S** 9 | 1 | .8 | 2

DISTRICT: 2 **21**
 BILLING CITY CODE: 17 **080**

TYPE CODE: 17 **080**
 CATEGORY: 18 **081**
 DATE: 12/22/78

PROPERTY OWNER NAME: 3 ~~09~~
 APPLICANT NAME: 4 **KERR-MC GEE CHEMICAL CORP.**
 PROPERTY LEGAL DESCRIPTION: 5 **Claude E. Cooke**

TOTAL FIXTURE UNITS: 18 **9**
 SUBDIVISION: 19 **No parcel map on file**
 MINIMUM SEPTIC TANK SIZE: 20 **1,000 Gal.**

STREET NO. FRACTION DIRECTION STREET NAME TYPE ROAD
 7 **Henderson Industrial Center, Lake Mead Dr**

MINIMUM LEACH FIELD SIZE: 21 **300 Sq.Ft.**
 LAND AREA: 22 **1 AC**

CITY: 8 **Las Vegas**
 PHONE: PREFIX NUMBER EXTENSION AREA CODE
 9 **565-8901**

TOTAL BEDROOMS/BATHS: 23 **N/A** BDRMS: **1** BATHS:
 24 **COMMERCIAL (CHEMICAL PLANT)**

SEPTIC TANK CONTRACTOR: 10 **Claude E. Cooke (Gen. Contractor)**
 WATER SUPPLIER: 11 **(B.I.M.) Basic Management Industries, Inc.**

WATER SUPPLY CONTROL NO. TYPE
 25
 26

SANITATION DISTRICT VERIFICATION: 12 **CCSD (Mike)**
 APPLICANT/OWNER FREE FORM ADDRESS: 13 **P. O. Box 55**

PARCEL NUMBER: 27 **520 210 090 0 05**
 PERMIT STATUS: 28
 EXPIRATION DATE: **6/22/79**

STREET NO. FRACTION DIRECTION STREET NAME TYPE ROAD
 14
 CITY: **Henderson** STATE: **NV** ZIP CODE: **89015**

29 **Receipt #A 12406**
 PREPARED BY: 30 **Rm Marvin**
 APPROVED BY: 31

PHONE: AREA CODE PREFIX NUMBER EXTENSION
 16 **565 8901**

IN THE SPACE PROVIDED BELOW DRAW A LAYOUT OF YOUR PROPOSED SEWAGE DISPOSAL SYSTEM. INCLUDE ALL PROPERTY LINES, WATER COURSES, WELLS, BUILDINGS, SWIMMING POOLS, TREES, WATER LINES, STREAMS, AND EXACT DISTANCE IN FEET.

Applicant agrees to discontinue use of septic system when public sewer becomes available. Septic system is to be properly abandoned.

FIXTURE	UNITS	NO.	TOTAL
WATER CLOSETS	6 ⁰⁰	1	6
BATHTUBS	2 ⁰⁰		
SHOWERS	2 ⁰⁰		
DOUBLE LAVATORIES	2 ⁰⁰		
SINGLE LAVATORIES	1 ⁰⁰	1	1
KITCHEN SINK/DISHWASHER	2 ⁰⁰		
CLOTHES WASHER	2 ⁰⁰		
OTHER:			
F/Drain	2 ⁰⁰	1	2
	00		
Total	00		9

No water courses within 100' of ISDS.
 At time of inspection, street address must be posted and lid must be off septic tank for interior inspection.

No Discharge Permit required per Mr. Claude E. Cooke's phone call to Lou Dodgion (Environmental Protection Services).

NO CHEMICAL WASTE TO ENTER SEPTIC SYSTEM. THIS INDUSTRIAL PERMIT IS ISSUED FOR TREATMENT OF HUMAN WASTE ONLY. ANY CHANGE IN DISCHARGE INTO THIS SEPTIC SYSTEM OR ANY TRANSFER OF THIS PROPERTY MUST HAVE THE APPROVAL OF CLARK COUNTY HEALTH DISTRICT FOR CONTINUED USE.

Claude E. Cooke
 Applicant signature

LOCATION OF ISDS APPROVED BASED ON PLAT MAP PRESENTED BY APPLICANT THIS DATE AND SUBJECT TO RELEASE OF EXISTING PATENT RIGHT OF WAY, IF ANY

C. Douglas Pughard
 APPLICATION APPROVED BY

Claude E. Cooke
 APPLICANT'S SIGNATURE

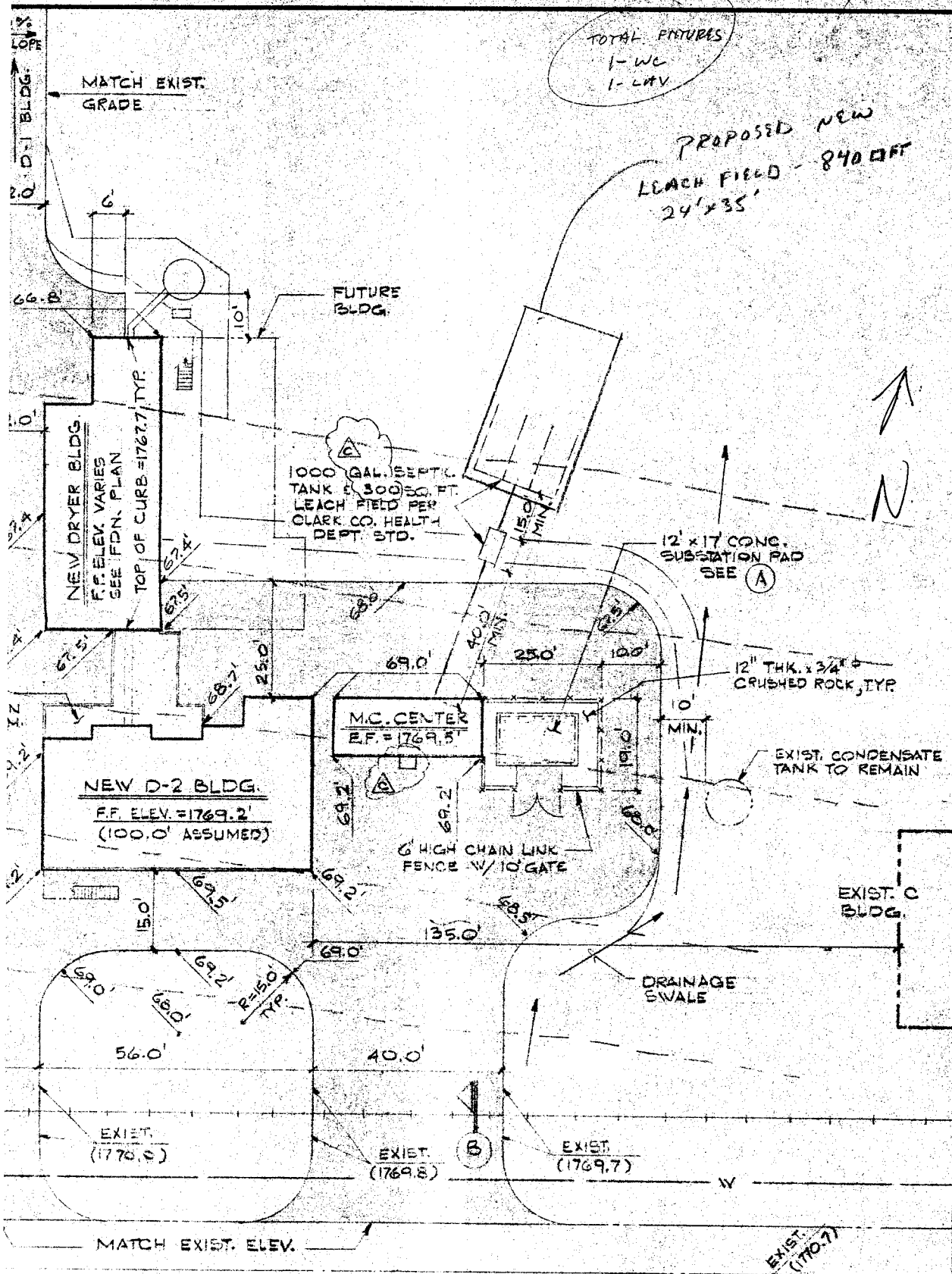

UT EXIST. A.C. PAVING
 OF NEW PAVING, TYP.