



NEVADA DIVISION OF
**ENVIRONMENTAL
PROTECTION**

STATE OF NEVADA
Department of Conservation & Natural Resources

Brian Sandoval, Governor
Bradley Crowell, Director
Greg Lovato, Administrator

December 11, 2018

Jay A. Steinberg
Nevada Environmental Response Trust
35 East Wacker Drive, Suite 1550
Chicago, IL 60601

Subject: No Further Action Determination – NERT Parcel H

Facility: Tronox LLC (TRX) Facility
Nevada Environmental Response Trust (Trust) Property
Clark County, Nevada
APNs 17813601005, 17813601002
NDEP Facility ID #H-000539

Dear Mr. Steinberg,

The Nevada Division of Environmental Protection (NDEP) has received and reviewed the October 8, 2018 Compilation of Select Health Risk Assessment Documents for Parcel H: 2008 to 2018 (Deliverable). This Deliverable was prepared under the responsible charge of Mr. John M. Pekala, CEM of Ramboll US Corporation on behalf of Nevada Environmental Response Trust (Trust) for the above-referenced areas. The Deliverable contains a request for a no further action determination from the NDEP.

The NDEP has reviewed the following information and has determined that no further assessment or remediation of soil is required:

1. A voluntary Environmental Covenant (“EC”) has been prepared and executed in accordance with Nevada Revised Statutes 445D relating to the prospective use of the subject property;
2. A formal human health risk assessment; and
3. Supporting technical data.

The EC was recorded as of December 3, 2018 with the Clark County Recorder office for the areas designated above, and therefore the EC (as may be amended in the future by agreement of NDEP and the owner of the property) is a matter of public record.

Parcel H is further depicted and described in the attachment of this letter. (Legal descriptions and map for Tronox Parcel H)

Should you have any questions or concerns, please do not hesitate to contact me at (702) 486-2850 x 252 or wdong@ndep.nv.gov.

Sincerely,



Weiquan Dong, P.E.
Bureau of Industrial Site Cleanup
NDEP-Las Vegas City Office
2030 E. Flamingo Rd, Suite 230
Las Vegas, NV. 89119

WD:cp

Attachment (Legal Description and Map of Parcel H)

EC:

Greg Lovato, Administrator, NDEP
Jeffrey Kinder, Deputy Administrator, NDEP
Frederick Perdomo, Nevada AG Office
James Dotchin, NDEP BISC Las Vegas
Carlton Parker, NDEP BISC Las Vegas
Allan Delorme, Ramboll Environ
Alison Fong, U.S. Environmental Protection Agency, Region 9
Andrew Barnes, Geosyntec
Andrew Steinberg, Nevada Environmental Response Trust
Anna Springsteen, Neptune & Company Inc.
Betty Kuo Brinton, MWDH2O
Brenda Pohlmann, City of Henderson
Brian Loffman, Lepetomane
Brian Waggle, Hargis + Associates
Carol Nagai, MWDH2O
Chinny Esakkiperumal, Olin Corporation
Chris Ritchie, Ramboll Environ
Chuck Elmendorf, Stauffer Management Company, LLC
Dan Pastor, P.E. TetraTech
Dave Share, Olin
Dave Johnson, LVVWD
David Parker, Central Arizona Water Conservation District
Derek Amidon, Tetrattech
Ebrahim Juma, Clean Water Team
Ed Modiano, de maximis, inc.
Eric Fordham, Geopentech
Gary Carter, Endeavour

George Crouse, Syngenta Crop Protection, Inc.
Harry Van Den Berg, AECOM
Jay Steinberg, Nevada Environmental Response Trust
Jeff Gibson, Endeavour
Jill Teraoka, MWDH2O
Joanne Otani
Joe Kelly, Montrose Chemical Corporation of CA
Joe Leedy, Clean Water Team
John Edgcomb, Edgcomb Law Group
John Pekala, Ramboll Environ
Kelly McIntosh, GEI Consultants
Kevin Fisher, LV Valley Water District
Kirk Stowers, Broadbent & Associates
Kirsten Lockhart, Neptune & Company Inc.
Kim Kuwabara, Ramboll Environ
Kurt Fehling, The Fehling Group
Kyle Gadley, Geosyntec
Kyle Hansen, Tetrattech
Lee Farris, BRC
Marcia Scully, Metropolitan Water District of Southern California
Maria Lopez, Water District of Southern California
Mark Duffy, U.S. Environmental Protection Agency, Region 9
Mark Paris, Landwell
Michael J. Bogle, Womble Carlyle Sandridge & Rice, LLP
Michael Long, Hargis +
Mickey Chaudhuri, Metropolitan Water District of Southern California
Nicholas Pogoncheff, PES Environmental, Inc.
Orestes Morfin, CAP
Paul Black, Neptune and Company, Inc.
Paul Hackenberry, Hackenberry Associates, LLC
Patti Meeks, Neptune & Company Inc.
Peggy Roefer, CRC
Ranajit Sahu, BRC
Richard Pfarrer, TIMET
Rick Kellogg, BRC
R9LandSubmit@EPA.gov
Scott Bryan, Central Arizona Project
Steve Clough, Nevada Environmental Response Trust
Steven Anderson, LVVWD
Tanya O'Neill, Foley & Lardner L
Todd Tietjen, SNWA

Attachment

Exhibit A
Legal Description



Atkins, Inc.
2270 Corporate Circle, Suite 200
Henderson, Nevada 89074-7755

Telephone: 702.263.7275
Fax: 702.263.7200

www.atkinaglobal.com/northamerica



**LEGAL DESCRIPTION
GATE 2 - PARCEL 2**

LOCATED IN SECTION 13, TOWNSHIP 22 SOUTH, RANGE 62 EAST, M.D.M., CLARK COUNTY, NEVADA, MORE PARTICULARLY DESCRIBED AS FOLLOWS:

COMMENCING AT THE NORTHWEST CORNER OF SECTION 18, TOWNSHIP 22 SOUTH, RANGE 63 EAST, M.D.M.; THENCE SOUTH 35°04'54" WEST, 2545.63 FEET TO THE NORTHERLY RIGHT-OF-WAY LINE OF LAKE MEAD PARKWAY; THENCE SOUTH 80°47'16" WEST, ALONG SAID NORTHERLY RIGHT-OF-WAY LINE, 471.63 FEET TO THE POINT OF BEGINNING; THENCE CONTINUING SOUTH 80°47'16" WEST, 866.59 FEET; THENCE NORTH 09°12'37" WEST, DEPARTING SAID NORTHERLY RIGHT-OF-WAY LINE, 770.13 FEET; THENCE NORTH 80°47'23" EAST, 763.22 FEET; THENCE SOUTH 09°15'32" EAST, 350.55 FEET TO THE BEGINNING OF A TANGENT CURVE CONCAVE NORTHEASTERLY HAVING A RADIUS OF 160.00 FEET; THENCE ALONG SAID CURVE TO THE LEFT THROUGH A CENTRAL ANGLE OF 21°31'26", AN ARC LENGTH OF 60.11 FEET; THENCE SOUTH 30°46'59" EAST, 168.88 FEET TO THE BEGINNING OF A TANGENT CURVE CONCAVE SOUTHWESTERLY HAVING A RADIUS OF 425.00 FEET; THENCE ALONG SAID CURVE TO THE RIGHT THROUGH A CENTRAL ANGLE OF 21°34'15", AN ARC LENGTH OF 160.00 FEET; THENCE SOUTH 09°12'44" EAST, 47.56 FEET TO THE POINT OF BEGINNING.

CONTAINING 14.10 ACRES (614,277 SQUARE FEET), MORE OR LESS, AS DETERMINED BY COMPUTER METHODS.

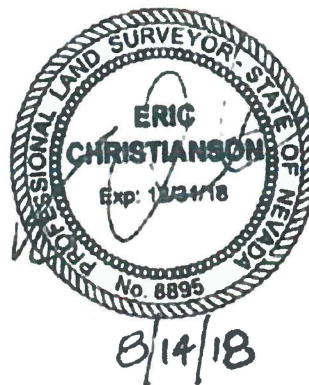



Atkins, Inc.
2270 Corporate Circle, Suite 200
Henderson, Nevada 89074-7755

Telephone: 702.263.7275
Fax: 702.263.7200

www.atkinsglobal.com/northamerica

Parcel H - East

**LEGAL DESCRIPTION
GATE 2 - PARCEL 3**

LOCATED IN SECTION 13, TOWNSHIP 22 SOUTH, RANGE 62 EAST, M.D.M., CLARK COUNTY, NEVADA, MORE PARTICULARLY DESCRIBED AS FOLLOWS:

COMMENCING AT THE NORTHWEST CORNER OF SECTION 18, TOWNSHIP 22 SOUTH, RANGE 63 EAST, M.D.M.; THENCE SOUTH 35°04'54" WEST, 2545.63 FEET TO THE NORTHERLY RIGHT-OF-WAY LINE OF LAKE MEAD PARKWAY, SAME BEING THE POINT OF BEGINNING; THENCE SOUTH 80°47'16" WEST, ALONG SAID NORTHERLY RIGHT-OF-WAY LINE, 405.63 FEET; THENCE NORTH 09°12'44" WEST, DEPARTING SAID NORTHERLY RIGHT-OF-WAY LINE, 14.71 FEET TO THE BEGINNING OF A TANGENT CURVE CONCAVE SOUTHWESTERLY HAVING A RADIUS OF 435.00 FEET; THENCE ALONG SAID CURVE TO THE LEFT THROUGH A CENTRAL ANGLE OF 21°34'15", AN ARC LENGTH OF 163.77 FEET; THENCE NORTH 30°46'59" WEST, 230.67 FEET TO THE BEGINNING OF A TANGENT CURVE CONCAVE NORTHEASTERLY HAVING A RADIUS OF 140.00 FEET; THENCE ALONG SAID CURVE TO THE RIGHT THROUGH A CENTRAL ANGLE OF 21°31'26", AN ARC LENGTH OF 52.59 FEET; THENCE NORTH 09°15'32" WEST, 555.28 FEET; THENCE SOUTH 89°11'25" EAST, 539.39 FEET; THENCE SOUTH 09°12'37" EAST, 901.92 FEET TO THE POINT OF BEGINNING.

CONTAINING 10.84 ACRES (472,061 SQUARE FEET), MORE OR LESS, AS DETERMINED BY COMPUTER METHODS.

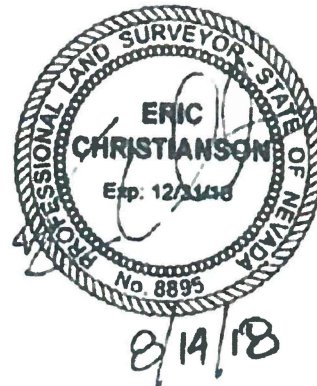

Exhibit B Parcel H Topography

