

## **APPENDIX D**

### **Diagrams of Sample Locations from Previous Reports**

---

Sample Location Maps for:

LOU # 5 Beta Ditch

LOU #6 Northwest Drainage Ditch

LOU #13 Pond S-1

LOU #14 Pond P-1

LOU #62 State Industries

LOU #63 J. B. Kelley Inc.

LOU #64 Koch Materials

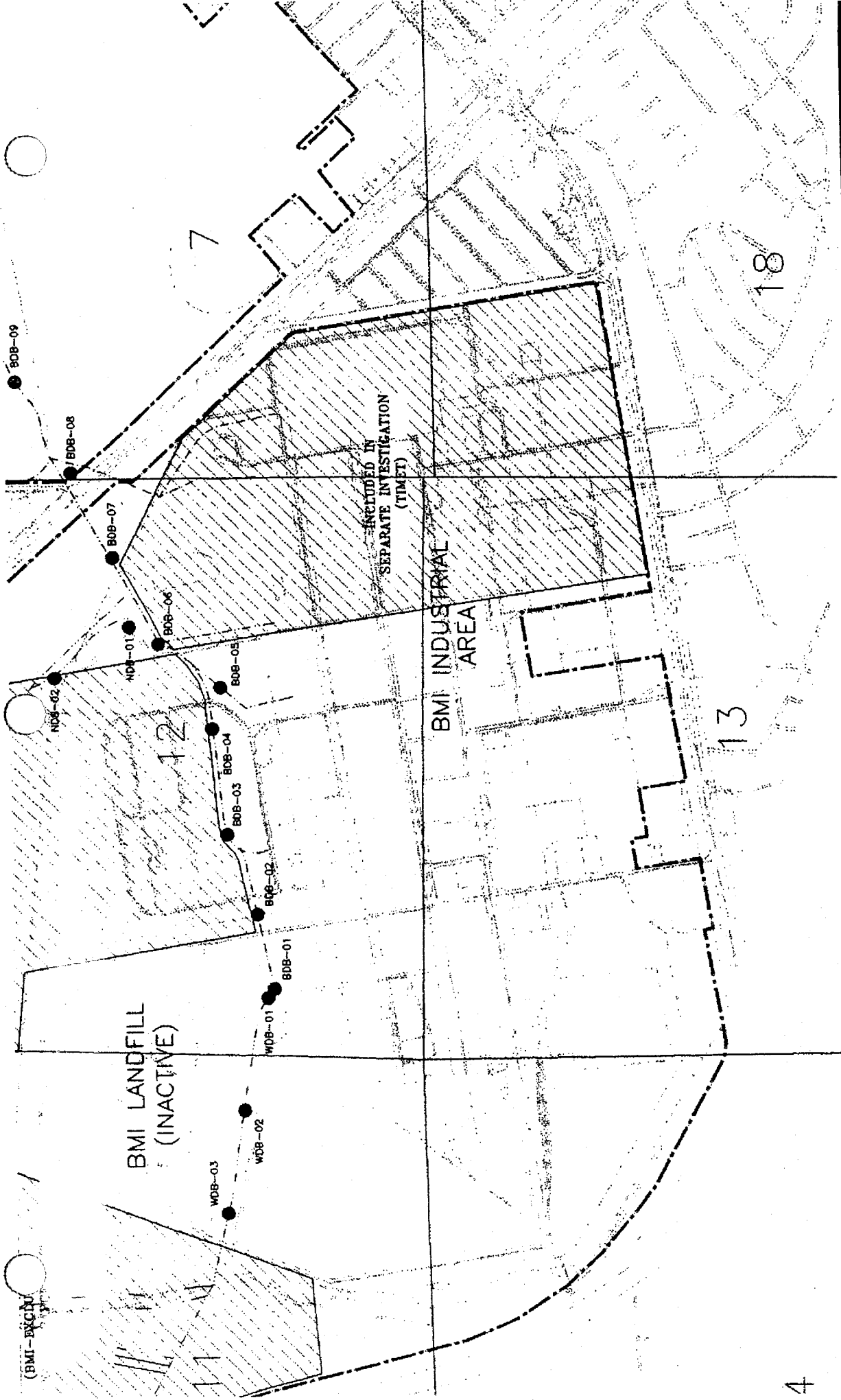

**LOU # 5**  
**Beta Ditch**  
 April 1996 Sample Locations  
 From: ERM, 1996, Draft Phase II  
 Investigative Report Associated with BMI  
 Common Areas



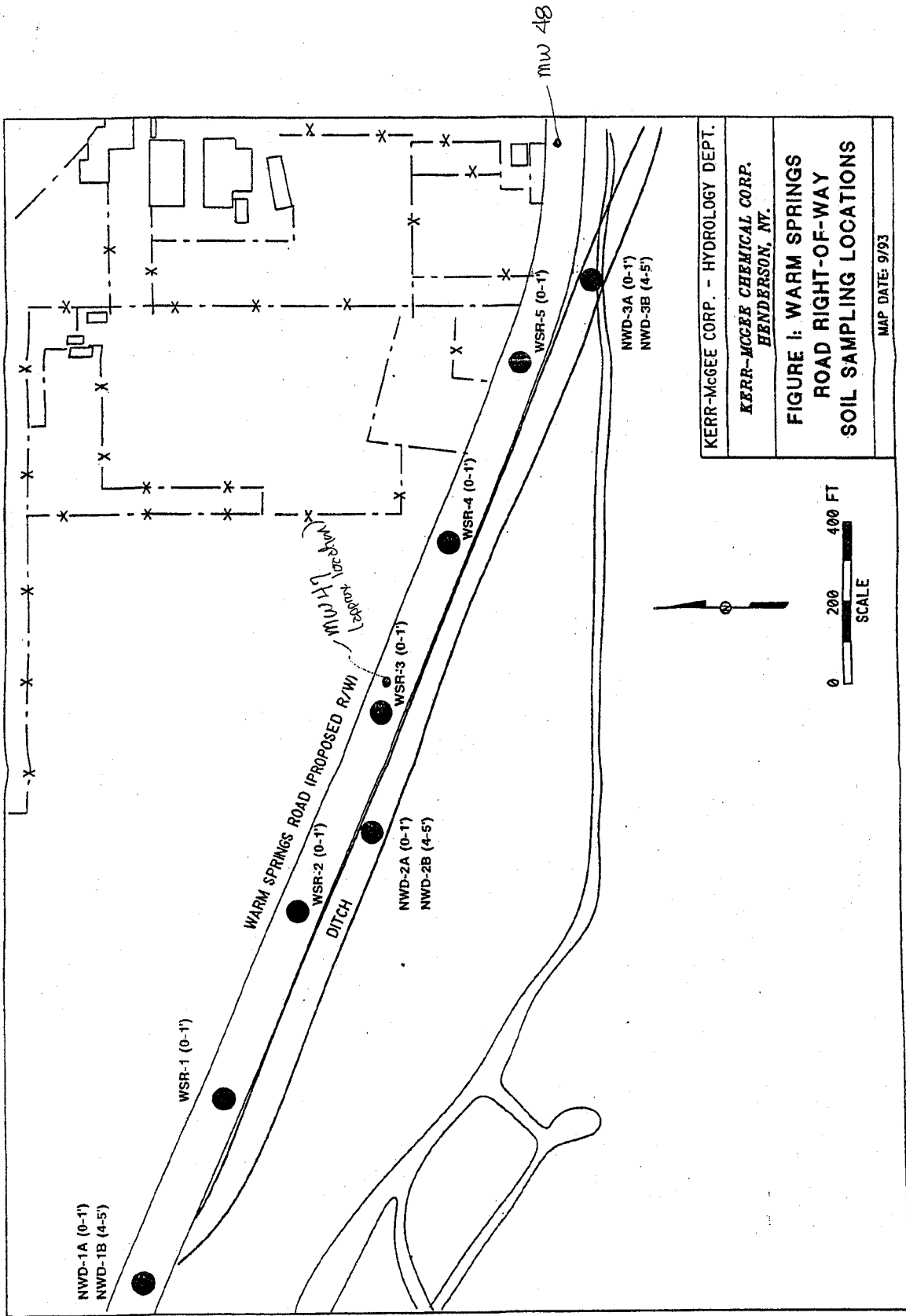

KERR-McGEE CORP. - HYDROLOGY DEPT.  
 KERR-McGEE CHEMICAL CORP.  
 HENDERSON, NY.  
**FIGURE 1: WARM SPRINGS  
 ROAD RIGHT-OF-WAY  
 SOIL SAMPLING LOCATIONS**  
 MAP DATE: 9/93

**LOU # 6**  
 Northwest Drainage Ditch  
 October 1993 Sample Locations  
 From: Kerr-McGee Chemical LLC

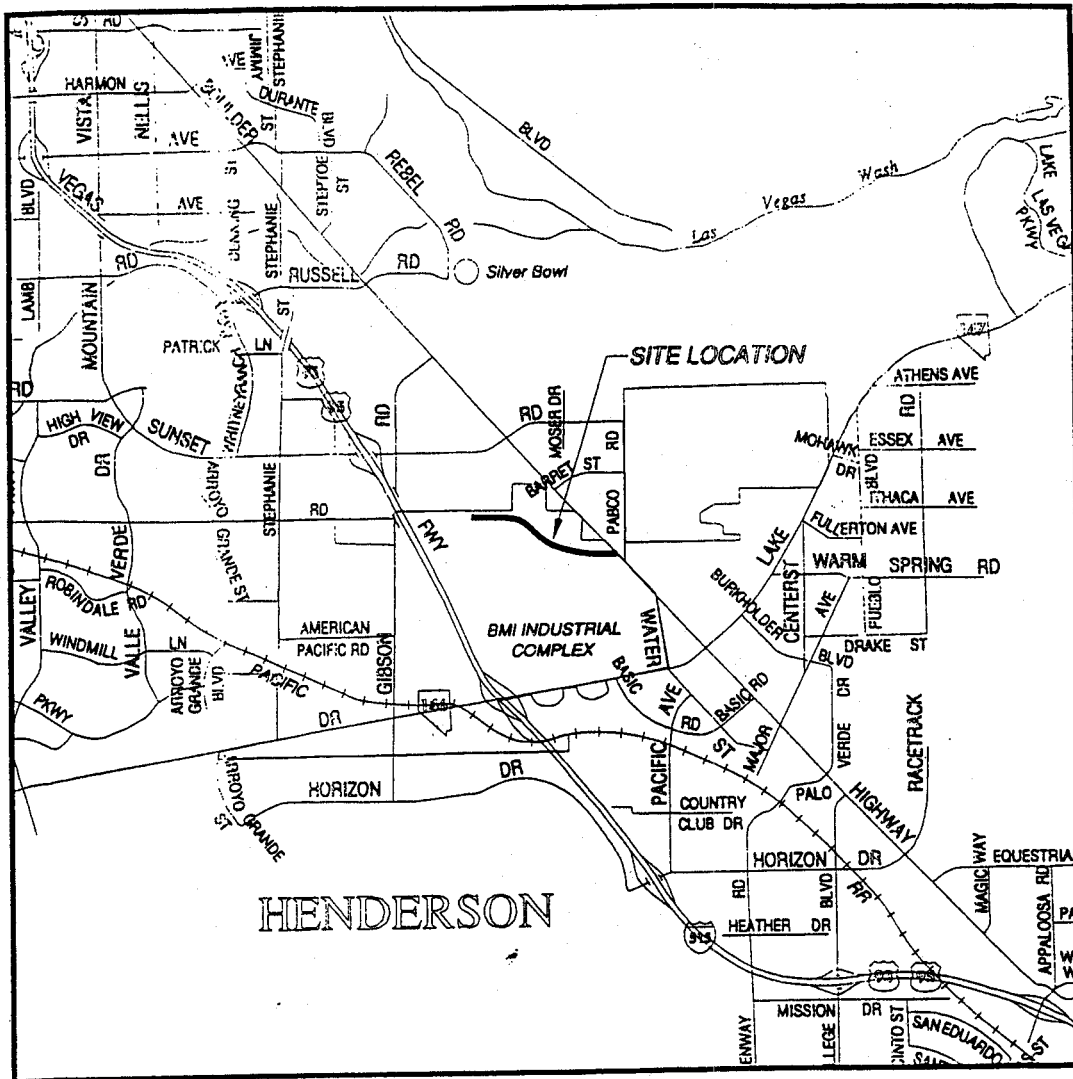

LOU # 6  
 Northwest Drainage Ditch  
 March 1996 Sample Locations  
 From: Western Technologies, 1996d,  
 Phase II Subsurface Soil Evaluation



NOT TO SCALE

Project:		<b>PHASE II WARM SPRINGS ROAD EXTENSION</b>	
Diagram:		<b>Vicinity Map</b>	
<b>Western Technologies Inc.</b>			
Job No.	<b>4186JL043</b>	Figure	<b>1</b>

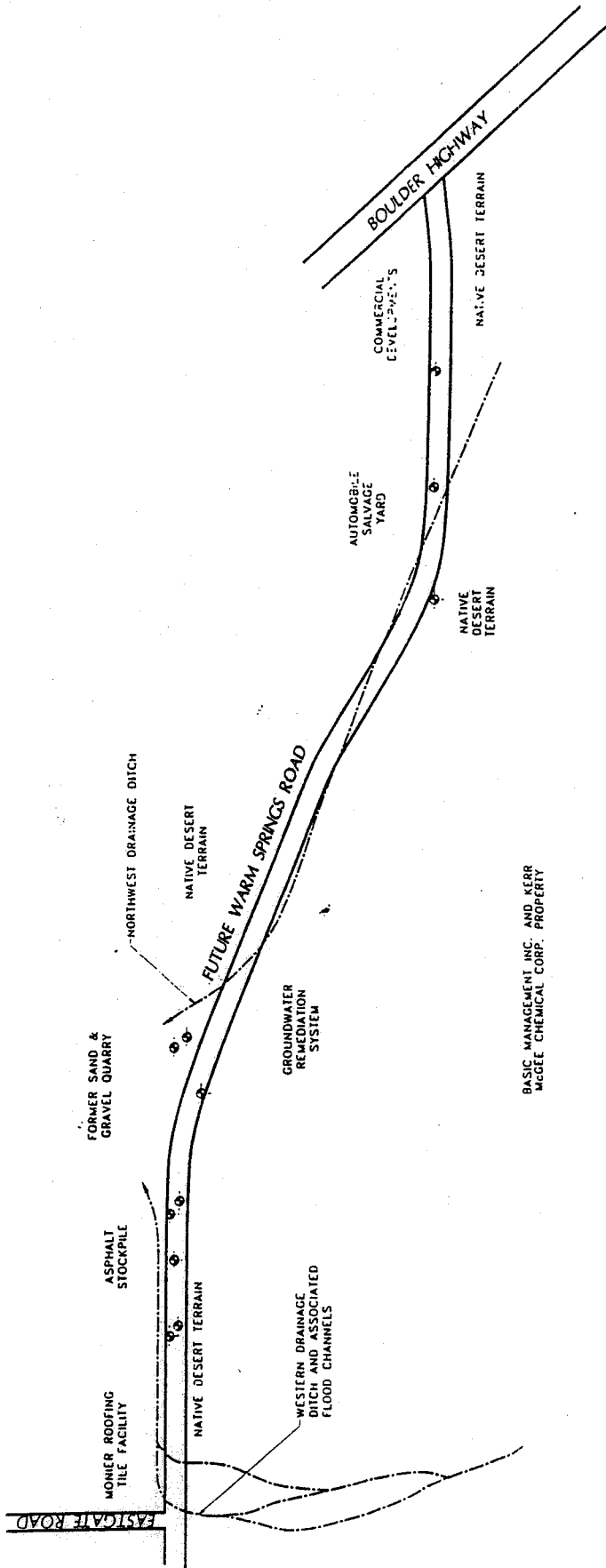

**LOU # 6**

**Northwest Drainage Ditch**

**March 1996 Sample Locations**

**From: Western Technologies, 1996d,**

**Phase II Subsurface Soil Evaluation**

Project	
PHASE II WARM SPRING ROAD EXTENSION	
Location	
Project Site Plan	
Client	
Western Technologies Inc.	
Job No.	4186JL043
Page	2

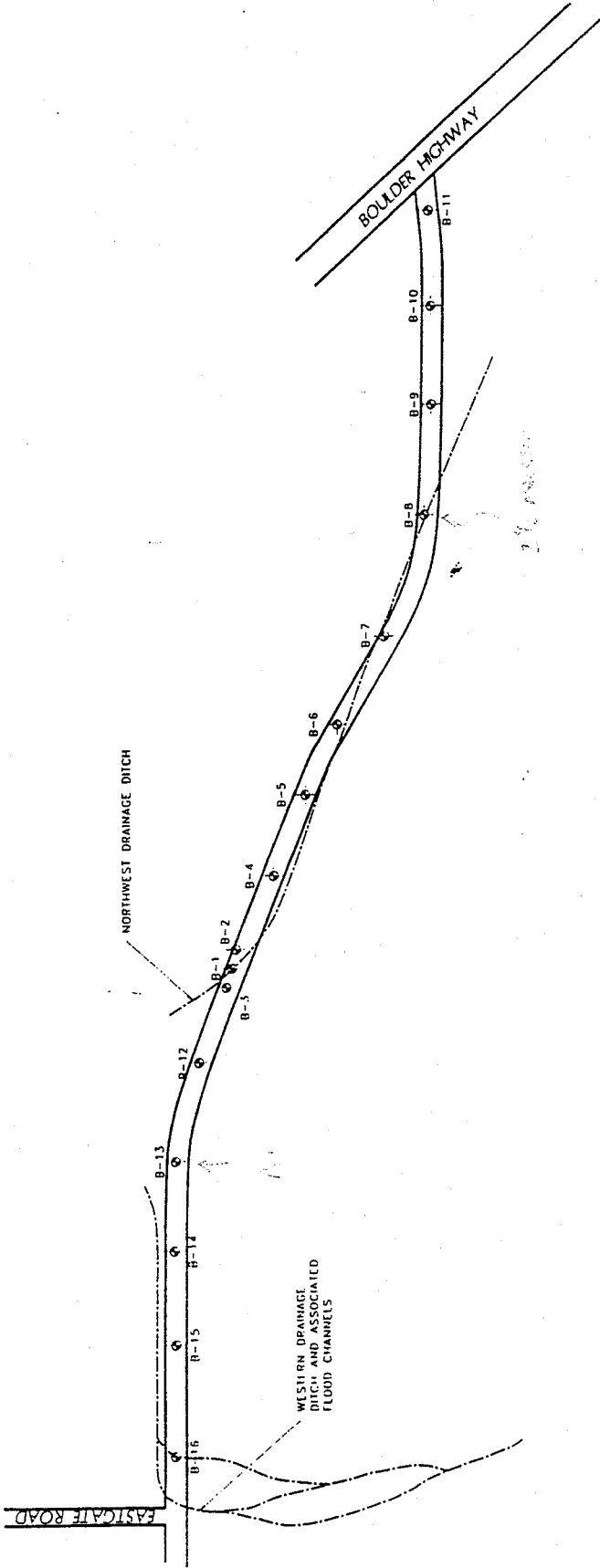

**LOU # 6**  
**Northwest Drainage Ditch**  
 March 1996 Sample Locations  
 From: Western Technologies, 1996d,  
 Phase II Subsurface Soil Evaluation

Project:	PHASE II WARM SPRING ROAD EXTENSION	
Diagram:	Site Boring Plan	
Job No.	4186JL043	Figure 3
Western Technologies Inc.		

LEGEND:  
 B-1 APPROXIMATE BORING LOCATION AND NUMBER

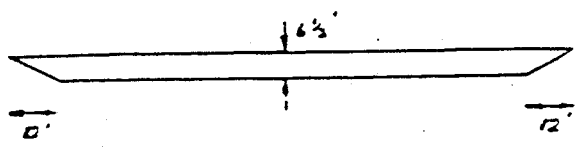
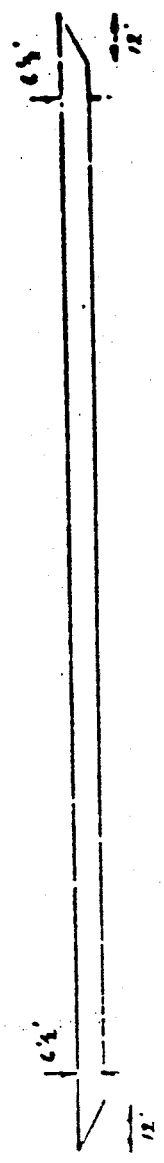
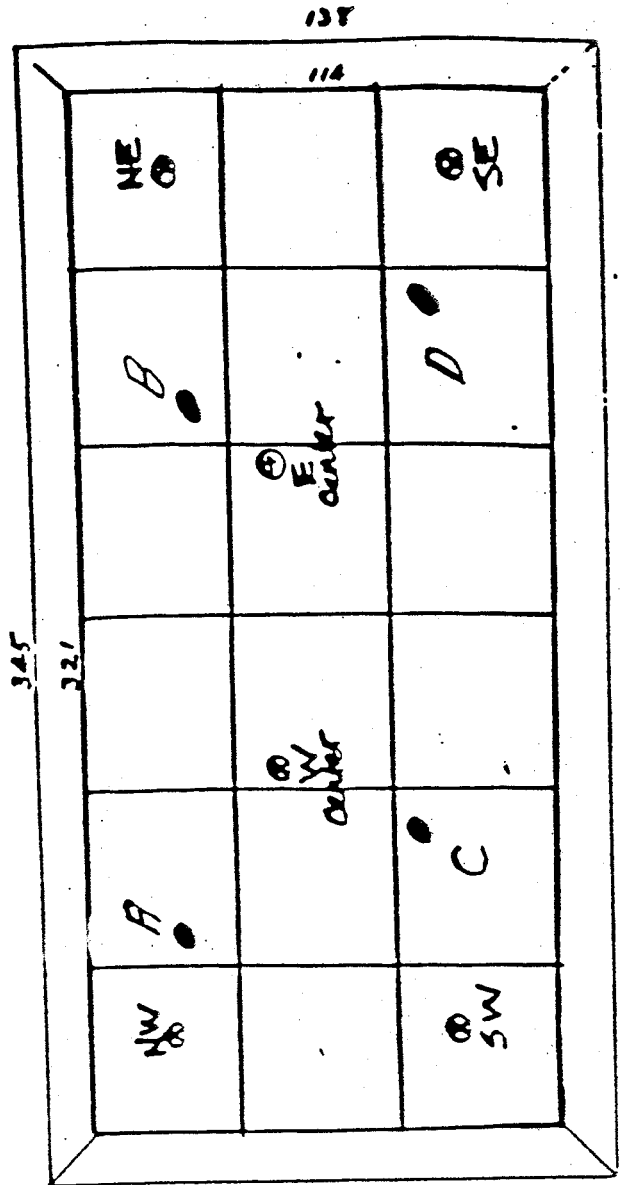

EVAPORATION POND S-1

LOU # 13  
 Pond S-1 Closure Documentation  
 August 1984 Chromium Sample  
Locations  
 From: Kerr-McGee, 1996b, Response to  
 Letter of Understanding



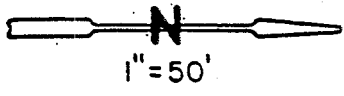
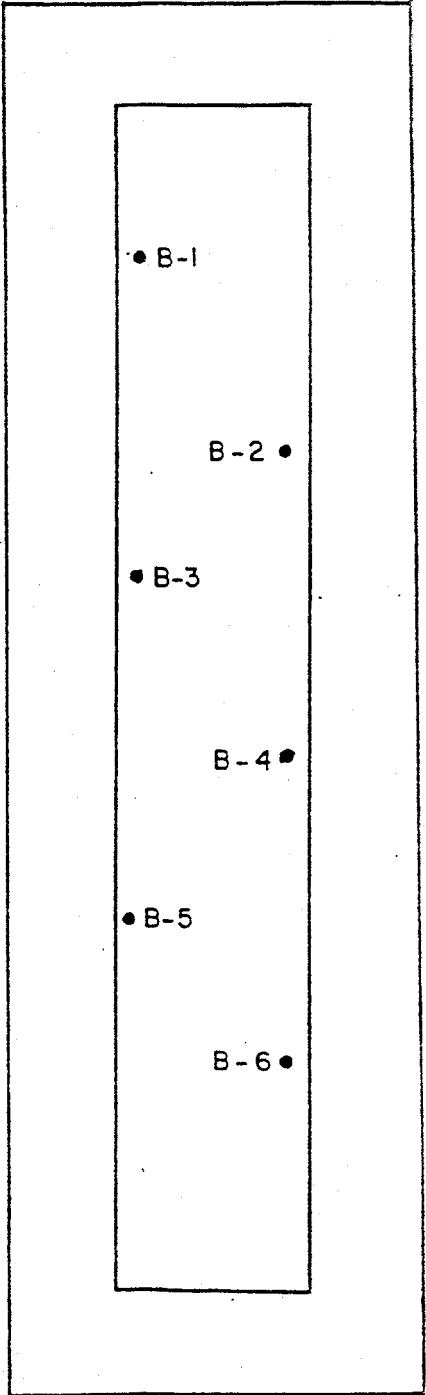

• B-2: Approximate Location of Exploratory Boring

LOU # 14  
 Pond P-1 Closure Documentation  
August 1985 Chromium Sample  
 Locations  
 From: Kerr-McGee, 1996b, Response to  
 Letter of Understanding

J.H. LEINFELDER & ASSOCIATES  
 GEOTECHNICAL CONSULTANTS • MATERIALS TESTING



PLOT PLAN  
 POND P-1

PROJECT NO. L-1359-3

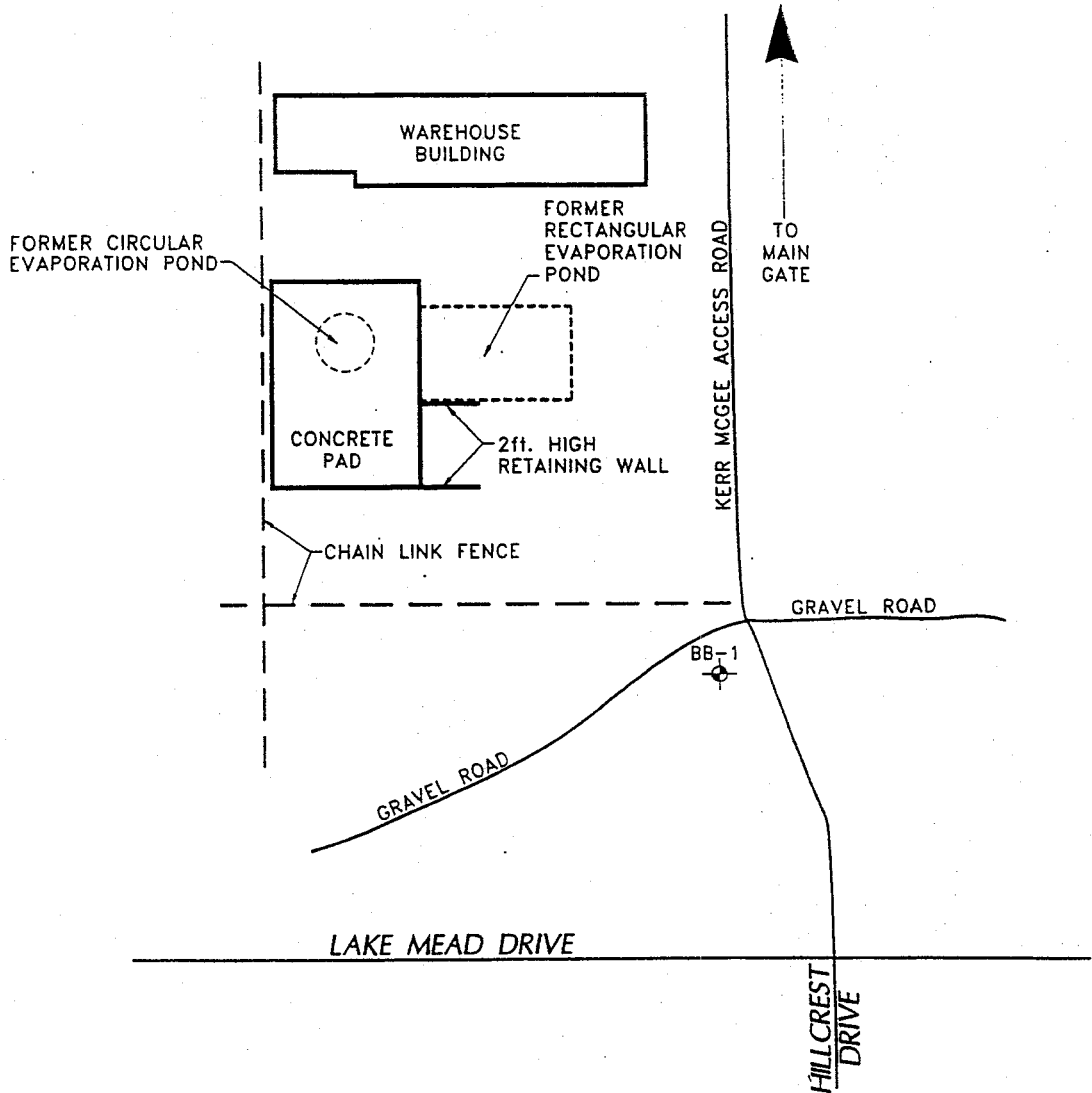

FOR BORING LOCATIONS AT RECTANGULAR POND SEE FIGURE 3  
 FOR BORING LOCATIONS AT CIRCULAR POND SEE FIGURE 4

**LOU # 62**  
**State Industries, Inc**  
Location of Rectangular & Circular Ponds  
 January 1996 Sample Locations  
 From: Kerr-McGee, 1996b, Response to Letter of Understanding

**LEGEND:**  
 -& APPROXIMATE BORING LOCATION

N  
 SCALE 1" = 300'

Project: <b>STATE INDUSTRIES - BMI COMPLEX</b>	
Diagram: <b>Site Plan</b>	
<b>Western Technologies Inc.</b>	
Job No. <b>4185JL164</b>	Figure <b>2</b>

STA 1  
 EN 1995/1/01

WAREHOUSE/FACTORY STRUCTURE

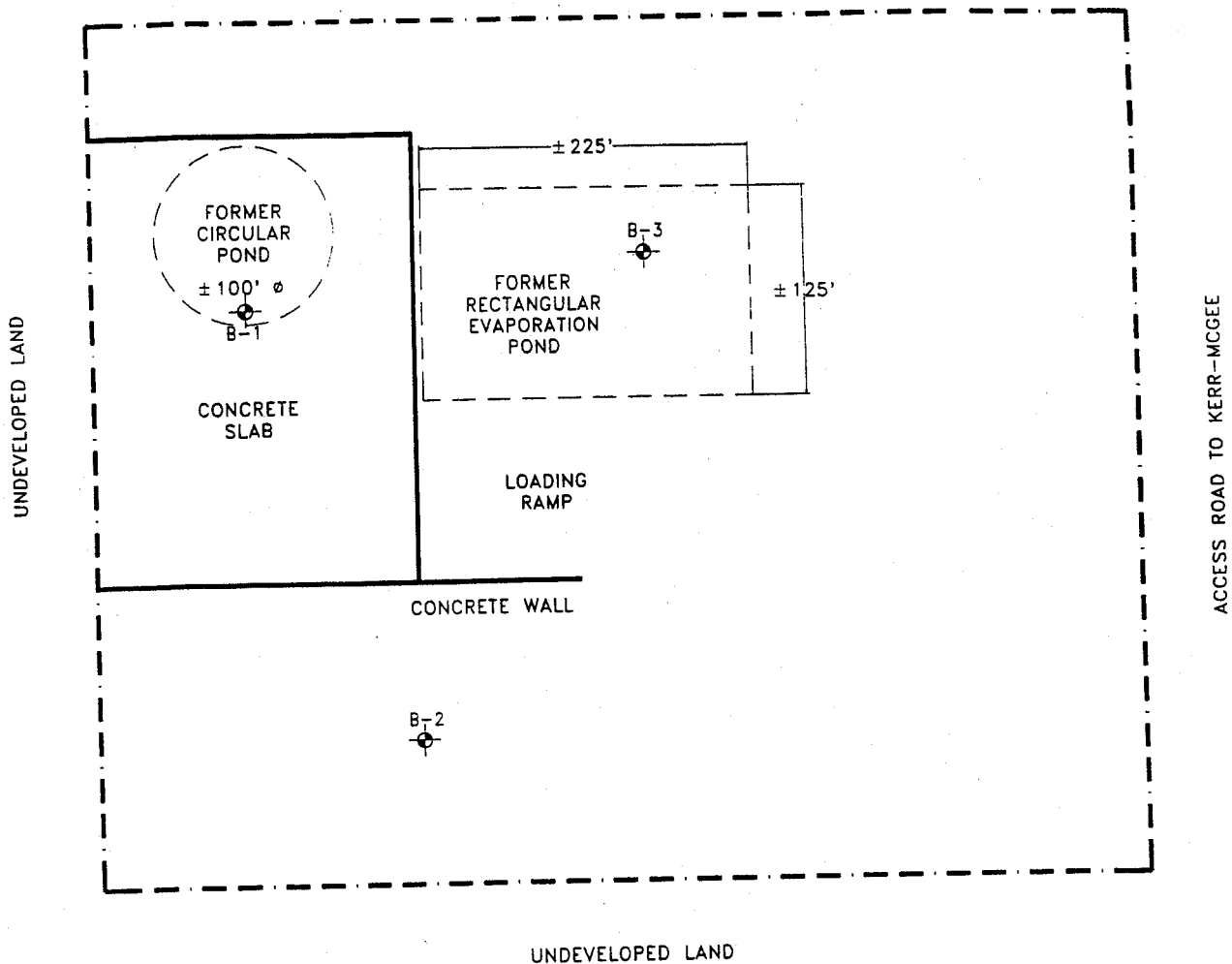

LOU # 62  
 State Industries, Inc  
 January 1996 Sample by State  
 Industries  
 From: Western Technologies, 1996a,  
 Subsurface Soil Evaluation Former  
 Evaporative Ponds Sites

**LEGEND:**  
 APPROXIMATE BORING LOCATION

  
 NOT TO SCALE

Project:	<b>STATE INDUSTRIES - BMI COMPLEX</b>	
Diagram:	<b>Boring Location Diagram</b>	
<b>Western Technologies Inc.</b>		
Job No.	<b>4185JL164</b>	Figure <b>2</b>

CA 02 11/24

# SITE PLAN / TEST BORING LOCATIONS



NORTH  
NO SCALE

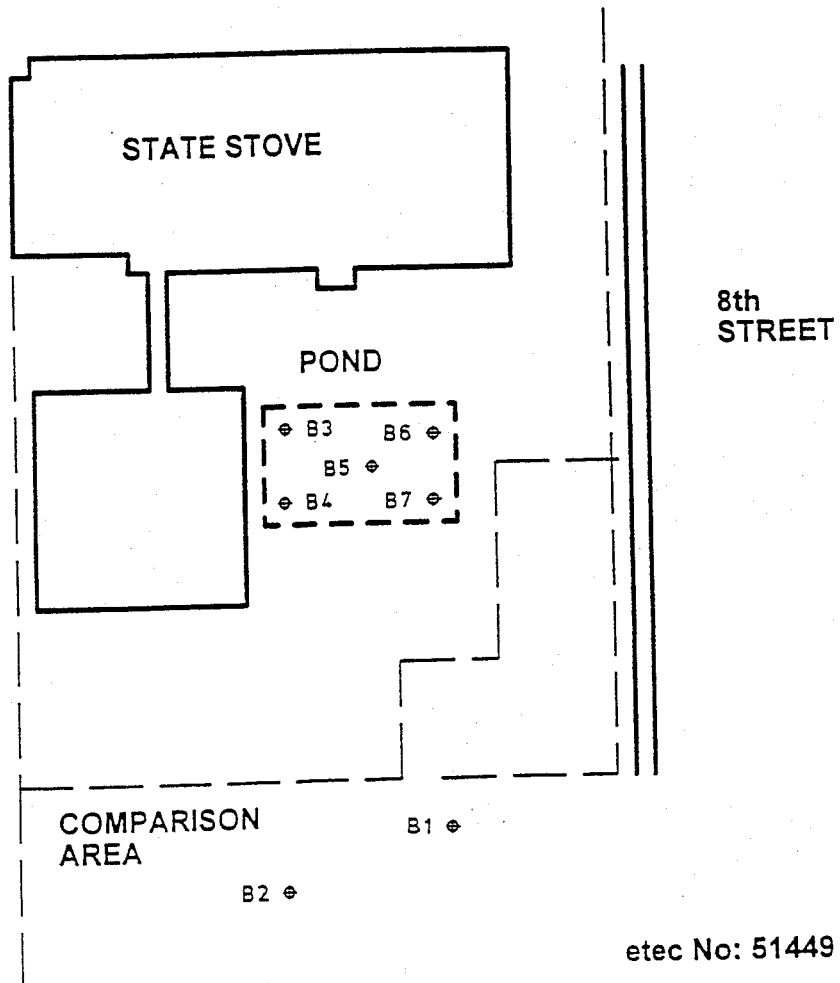

etec No: 51449

**LOU # 62**  
**State Industries, Inc**  
Rectangular Pond Sample Locations  
November 1995 Sample by Kerr-McGee  
Chemical LLC Facility  
From: ETEC, 1995, Geotechnical  
Investigation Report, Administration/Office  
Building

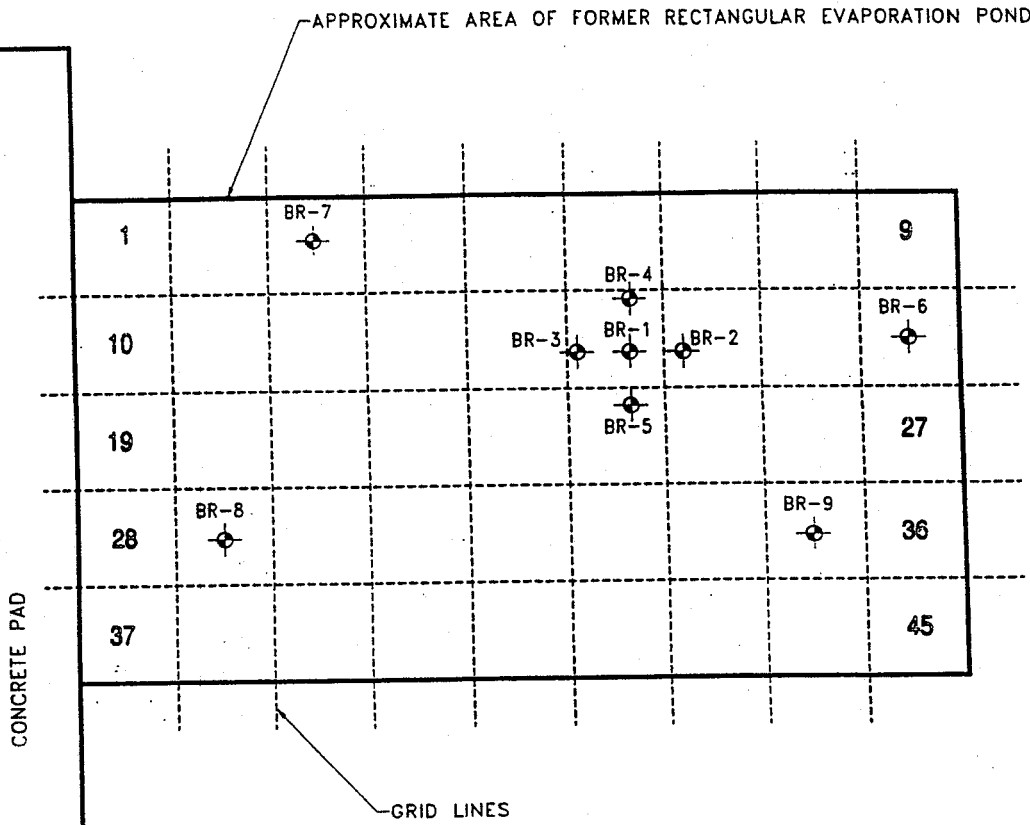

NUMBER OF GRIDS: 45  
 GRID SIZE: 25' x 25'  
 GRID NUMBERS RANDOMLY SELECTED: 18,3,29,35

**LOU # 62**  
**State Industries, Inc**  
 Rectangular Pond Sample Locations  
 January 1996 Sample Locations  
 From: Kerr-McGee, 1996b, Response to  
 Letter of Understanding

**LEGEND:**  
 [Symbol] BORING LOCATION AND NUMBER  
 BR-2



1" = 50'

Project: <b>STATE INDUSTRIES - BMI COMPLEX</b>	
Diagram: <b>RECTANGULAR EVAPORATION POND GRID PATTERN/BORING LOCATION</b>	
<b>Western Technologies Inc.</b>	
Job No. <b>4185JL164</b>	Figure <b>3</b>

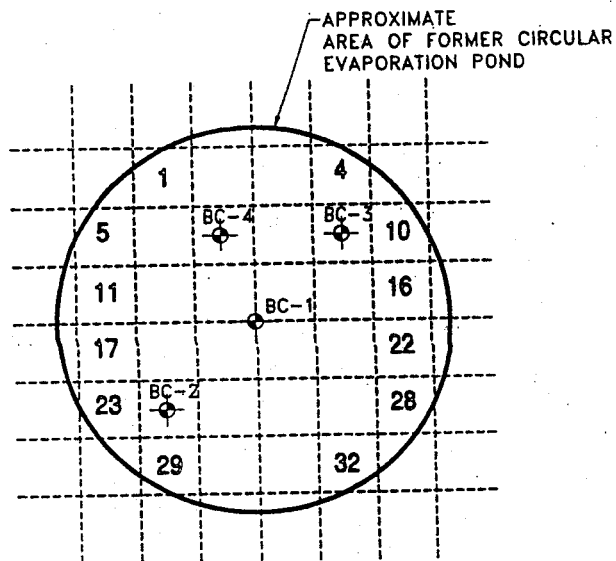

NUMBER OF GRIDS: 32  
 GRID SIZE: 15' x 15'  
 GRID NUMBERS RANDOMLY SELECTED: 24,9,7

**LOU # 62**  
**State Industries, Inc**  
 Circular Pond Sample Locations  
 January 1996 Sample Locations  
 From: Kerr-McGee, 1996b, Response to  
 Letter of Understanding

**LEGEND:**

BORING LOCATION AND NUMBER  
 BC-2



Project: **STATE INDUSTRIES - BMI COMPLEX**

Diagram: **CIRCULAR EVAPORATION POND  
 GRID PATTERN/BORING LOCATION**

**Western Technologies Inc.**

Job No. **4185JL164**

Figure **4**

# URAL GAS FLOW

1784.5

Tanks

1794.0

1789.0

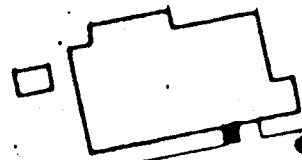

1794.5

NOTE: SAMPLES 2-13 WERE COLLECTED FROM BORINGS LESS THAN 5' FROM EXCAVATION.

1796.5

1796.0

1796.0

TO SAME (SEE PLAN)

SAMPLES # 6, 7, 8, 9

SAMPLES # 2, 3, 4, 5

SAMPLES # 18, 19, 20, 21 (APPROX 50' FROM EXCAV.)

1796.0

SAMPLES # 14, 15, 16, 17 (APPROX 50' FROM EXCAV.)

1795.5

SAMPLES # 22, 23, 24, 25 FROM APPROX 200' FROM EXCAVATION

1800

Asphalt

1811.0

LOU # 63  
J.B. Kelley, Inc.  
January 1992 Sample Locations  
From: Kerr-McGee, 1996b, Response to Letter of Understanding

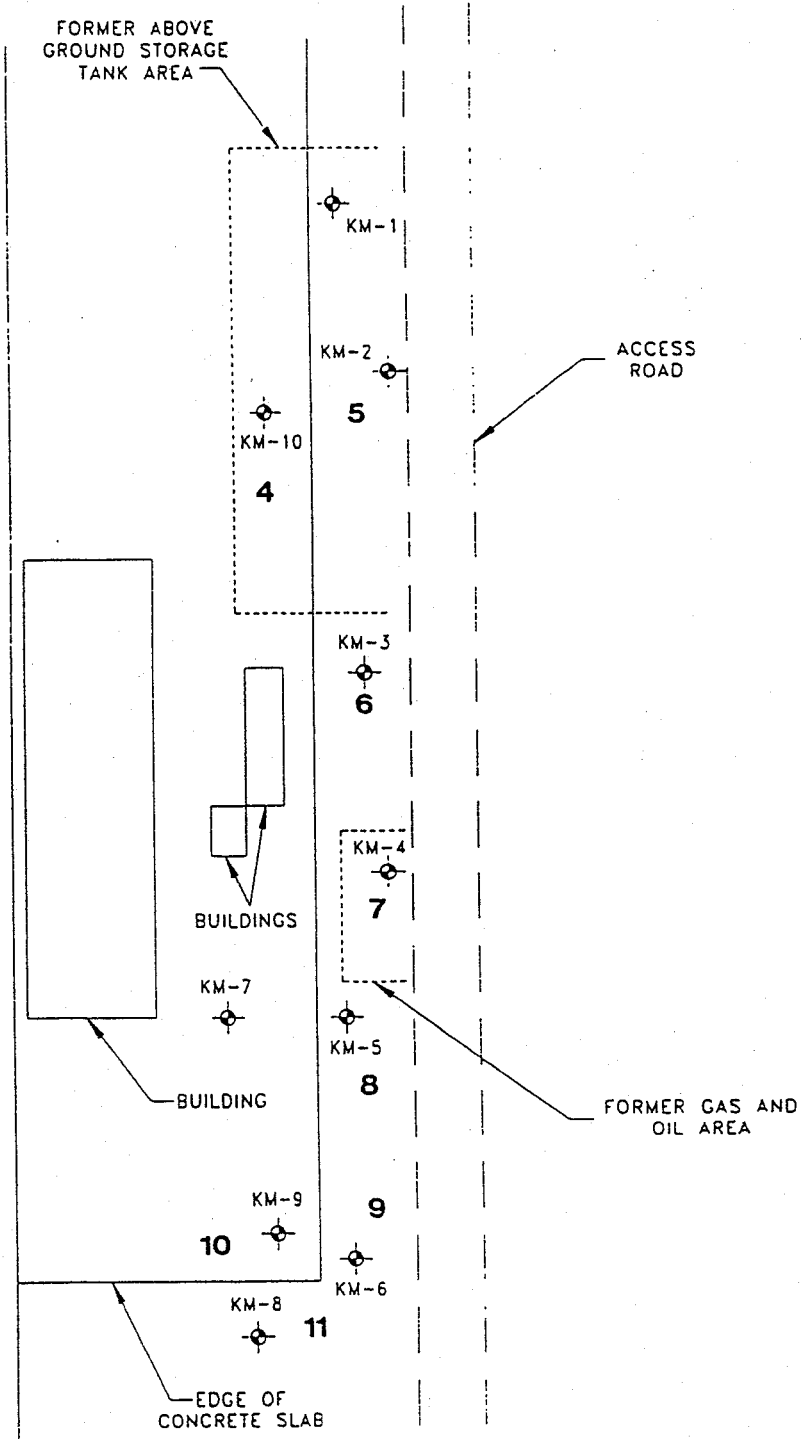

**LOU # 64**  
**Koch Materials**  
**March 1996 Sample Locations**  
 From: Kerr-McGee, 1996b, Response to  
 Letter of Understanding

**LEGEND:**  
 KM-2  
 ⊕ APPROXIMATE BORING LOCATION  
 AND NUMBER



NOT TO SCALE

Project:	<b>FORMER KOCH MATERIALS</b>	
Diagram:	<b>SITE PLAN</b>	
<b>Western Technologies Inc.</b>		
Job No.	<b>4186JL080</b>	Figure <b>1</b>



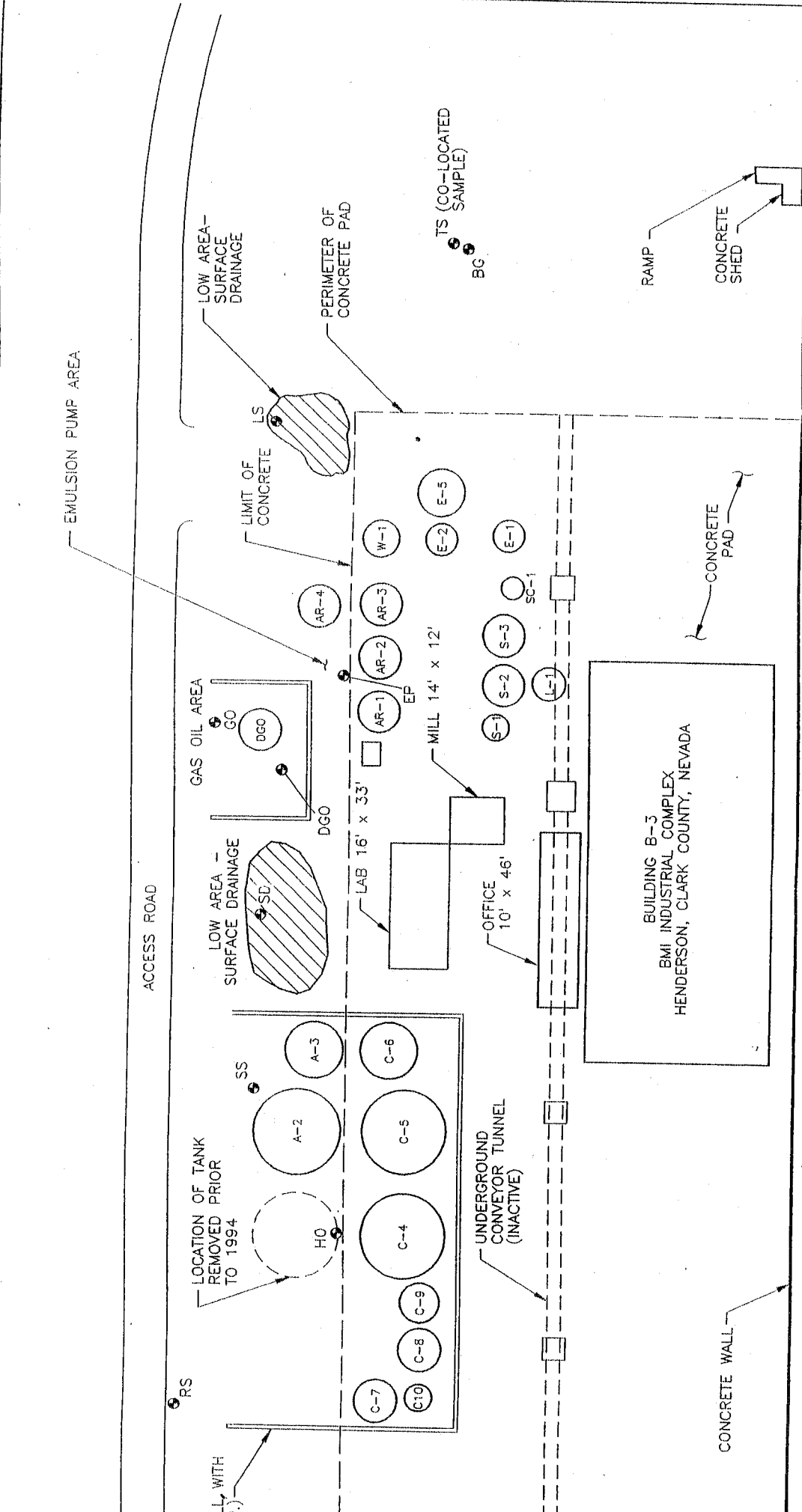

**LEGEND:**

- HO ● BORING LOCATION AND DESIGNATION
- A-1 ○ EMULSION TANK
- C-6 ○ EMULSION TANK (FINISHED PRODUCT)
- W-1 ○ WATER TANK
- DGO ○ GAS OIL TANK
- SOLUTION CONCENTRATE TANK
- L-1 ○ LATEX TANK
- S-3 ○ SOAP SOLUTION TANK
- E-1 ○ EMULSIFIER TANK
- ASPHALT TANK

**NOTE:**

1. THIS DRAWING IS NOT TO SCALE.

LOU # 64  
**Koch Materials**  
 November 1994 Sample Locations  
 From: Canone Environmental, 1995,  
 Phase II Environmental Site Assessment

SITE LAYOUT SHOWING  
 SOIL BORING LOCATIONS  
 PREPARED FOR

KOCH MATERIALS COMPANY  
 HENDERSON, NEVADA  
**Canone Environmental**

DATE: 11-23-94  
 SCALE: N.T.S.

FIGURE 1  
 DRAWING NUMBER  
 94-168-B1

DATE	11/23/94
DRAWN BY	ATSE
CHECKED BY	AP/O BT