

DESIGNED BY:	REVISIONS:	NO:	DESCRIPTION:	DATE:	BY:
NGEM					
DRAWN BY:					
NGEM					
CHECKED BY:					
NGEM					
APPROVED BY:					
NGEM					

LEGEND

- ChemStar Property
- GW-11, WC-West and WC-East Ponds
- Site features (Buildings and Tanks)
- Subarea Boundary
- LOU Boundaries
- Analytes Not Detected Above BCL
 - Phase A Sample Location (2006)
 - Phase B Sample Location (2008-2009)
- Analytes Detected Above BCL
 - Phase A Sample Location (2006)
 - Phase B Sample Location (2008-2009)
- Impacted by compounds that exceed BCL at 2 feet bgs (2,200 ng/kg criteria used for Dioxin)
- Associate LOU Pipelines
- LOU #59 Storm Sewer System manholes and sumps with flow direction
- LOU #60 Acid Drain System manholes and sumps with flow direction
- LOU 20 pipeline
- Groundwater recharge trenches to be retained
- Groundwater barrier wall to be retained
- dup Field Duplicate
- TPH-d Diesel Range Organics
- TPH-oil Oil Range Organics
- HCB Hexachlorobenzene

Notes:
 1. Asbestos data limited to greater than or equal to 1 amphibole and greater than 5 chrysotile fibers.
 2. Units for asbestos is number of fibers and dioxin is ng/kg.
 All other units are in mg/kg.

Coordinate Projection: Stateplane, Nevada East, NAD83, Feet
 Base Aerial Photo from AEX, May, 2007

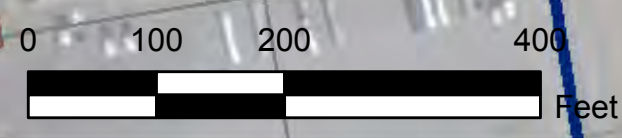
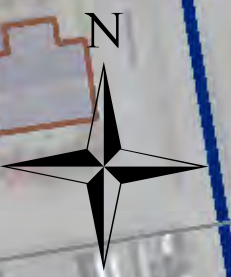
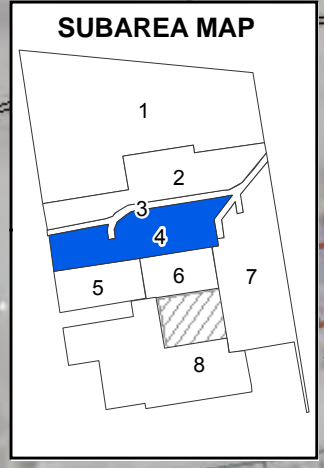

LOU Areas Within Soil Subarea 4

LOU 16-17 - Ponds AP-1 through AP-3 and Associated Transfer Lines
 LOU 38 - Former Satellite Accumulation Point, AP Laboratory
 LOU 39 - Satellite Accumulation Point, AP Maintenance Shop
 LOU 52 - AP Plant Screening and Drying Building and Associated Piping
 LOU 53 - AP Plant Area Tank Farm
 LOU 54 - AP Plant Area Change House/ Laboratory Septic Tank
 LOU 57 - AP Plant Transfer Lines to Sodium Chlorate

SOIL SUBAREA 4
AMMONIUM PERCHLORATE PRODUCTION AREA
 Tronox Facility
 Henderson, Nevada

SCALE: AS SHOWN
 DATE: 01/29/10
 PROJECT NUMBER: 2027.01

FIGURE NUMBER:
4-5
 SHEET NUMBER:
 1

I:\ng-em\1\NG-GIS\1_Projects\2027_Tronox\Phase_B\Remediation\Soil_Subarea4_South-Bare-ditch.mxd Last updated: 1/29/2010 5:42:49 AM