



NEVADA DIVISION OF  
**ENVIRONMENTAL  
PROTECTION**

**STATE OF NEVADA**  
Department of Conservation & Natural Resources

Brian Sandoval, Governor  
Bradley Crowell, Director  
Greg Lovato, Administrator

June 21, 2018

Jay A. Steinberg  
Nevada Environmental Response Trust  
35 East Wacker Drive, Suite 1550  
Chicago, IL 60601

Re: **Tronox LLC (TRX) Facility**  
**Nevada Environmental Response Trust (Trust) Property**  
**NDEP Facility ID #H-000539**  
Nevada Division of Environmental Protection (NDEP) Response to: *Phase 2 Remedial Investigation Modification No. 11 (Soil Gas Sampling)*  
Dated: May 23, 2018

Dear Mr. Steinberg,

The NDEP has received and reviewed the Trust's above-identified Deliverable and finds that the document is acceptable with the following comments noted for the Administrative Record:

1. NDEP suggests additional locations for soil gas sampling (See attached Figures 1 and 2: additional suggested sampling locations show as pink filled square within pink circle).

Please contact the undersigned with any questions at [wdong@ndep.nv.gov](mailto:wdong@ndep.nv.gov) or 702-486-2850 x252.

Sincerely,

Weiquan Dong, P.E.  
Bureau of Industrial Site Cleanup  
NDEP-Las Vegas City Office

WD:cp

EC:

James Dotchin, NDEP BISC Las Vegas  
Carlton Parker, NDEP BISC Las Vegas  
Allan Delorme, Ramboll Environ  
Alison Fong, U.S. Environmental Protection Agency, Region 9  
Andrew Barnes, Geosyntec  
Andrew Steinberg, Nevada Environmental Response Trust  
Anna Springsteen, Neptune & Company Inc.  
Betty Kuo Brinton, MWDH2O  
Brenda Pohlmann, City of Henderson  
Brian Waggle, Hargis + Associates  
Carol Nagai, MWDH2O

Chinny Esakkiperumal, Olin Corporation  
Chris Ritchie, Ramboll Environ  
Chuck Elmendorf, Stauffer Management Company, LLC  
Dan Pastor, P.E. TetraTech  
Dave Share, Olin  
Dave Johnson, LVVWD  
David Parker, Central Arizona Water Conservation District  
Derek Amidon, Tetrattech  
Ebrahim Juma, Clean Water Team  
Ed Modiano, de maximis, inc.  
Eric Fordham, Geopentech  
Gary Carter, Endeavour  
George Crouse, Syngenta Crop Protection, Inc.  
Harry Van Den Berg, AECOM  
Jay Steinberg, Nevada Environmental Response Trust  
Jeff Gibson, Endeavour  
Jill Teraoka, MWDH2O  
Joanne Otani  
Joe Kelly, Montrose Chemical Corporation of CA  
Joe Leedy, Clean Water Team  
John Edgcomb, Edgcomb Law Group  
John Pekala, Ramboll Environ  
Kelly McIntosh, GEI Consultants  
Kevin Fisher, LV Valley Water District  
Kirk Stowers, Broadbent & Associates  
Kirsten Lockhart, Neptune & Company Inc.  
Kim Kuwabara, Ramboll Environ  
Kurt Fehling, The Fehling Group  
Kyle Gadley, Geosyntec  
Kyle Hansen, Tetrattech  
Lee Farris, BRC  
Marcia Scully, Metropolitan Water District of Southern California  
Maria Lopez, Water District of Southern California  
Mark Duffy, U.S. Environmental Protection Agency, Region 9  
Mark Paris, Landwell  
Michael J. Bogle, Womble Carlyle Sandridge & Rice, LLP  
Michael Long, Hargis + Associates  
Micheline Fairbank, AG Office  
Mickey Chaudhuri, Metropolitan Water District of Southern California  
Nicholas Pogoncheff, PES Environmental, Inc.  
Orestes Morfin, CAP  
Paul Black, Neptune and Company, Inc.  
Paul Hackenberry, Hackenberry Associates, LLC  
Patti Meeks, Neptune & Company Inc.  
Peggy Roefler, CRC  
Ranajit Sahu, BRC  
Richard Pfarrer, TIMET  
Rick Kellogg, BRC  
Scott Bryan, Central Arizona Project  
Steve Clough, Nevada Environmental Response Trust  
Steven Anderson, LVVWD  
Tanya O'Neill, Foley & Lardner L  
Todd Tietjen, SNWA

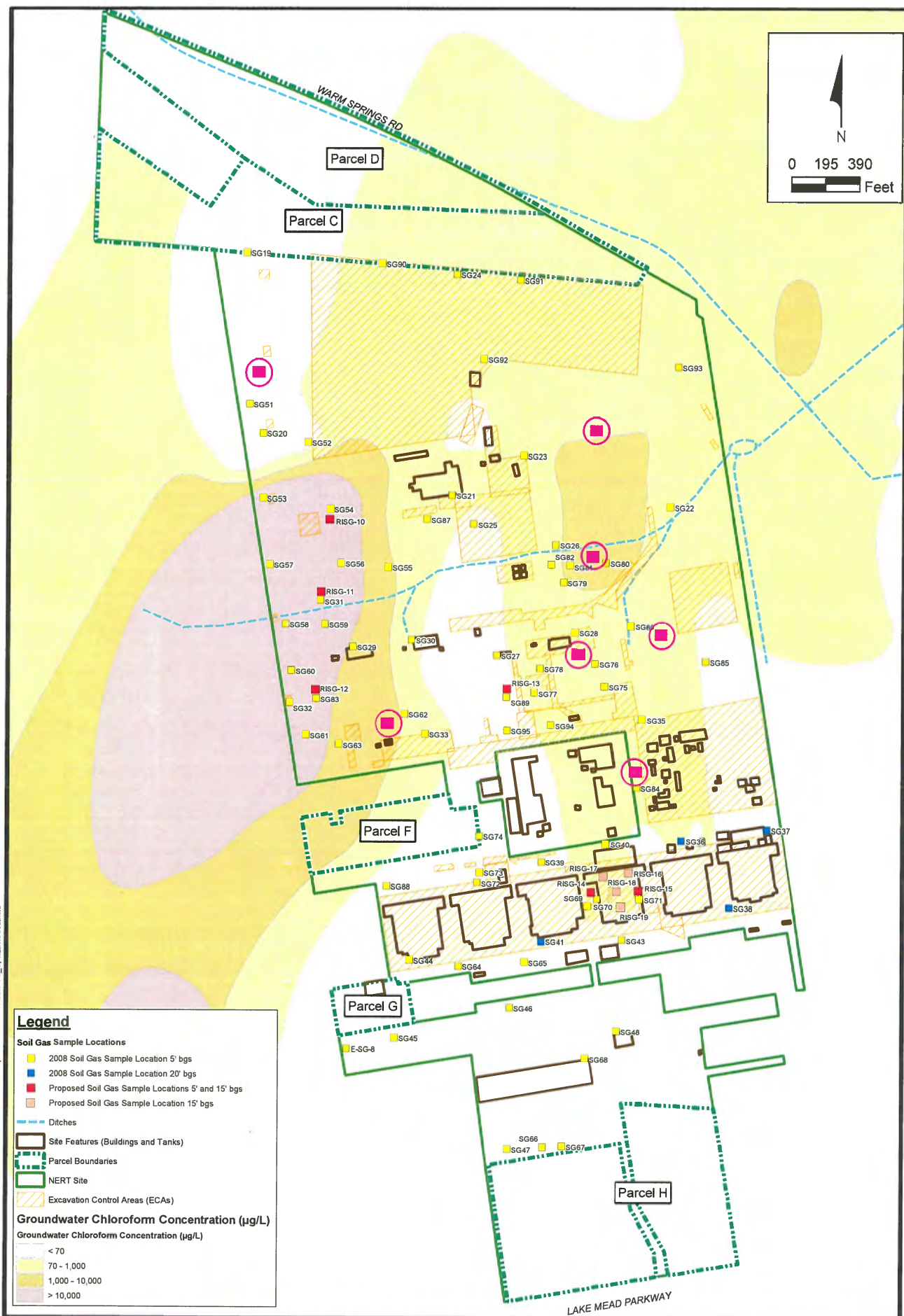

Path: H:\LaPelomane\NERT\Risk Assessment\Human Health\2017 COPC-EU Update\SG and GW Data\SG\_Concentration.mxd



**Proposed Soil Gas Sample Locations in OU-1  
(Chloroform Plume as Depicted in 2017)  
Nevada Environmental Response Trust Site, Henderson, Nevada**

Figure  
**1**

Drafter: RS    Date: 4/13/2018    Contract Number: 169000 6943-012    Approved by:    Revised:



**Legend**

- Existing Groundwater Sample Locations
- Previous Soil Gas Sample Locations
- Proposed Soil Gas Sample Locations 5' and 15' bgs
- Operating Units
- Eastside Sub-Area
- Off-Site NERT Study Area
- NERT Site Boundary
- Groundwater Chloroform Concentration (µg/L)**
- < 70
- 70 - 1,000
- 1,000 - 10,000
- > 10,000

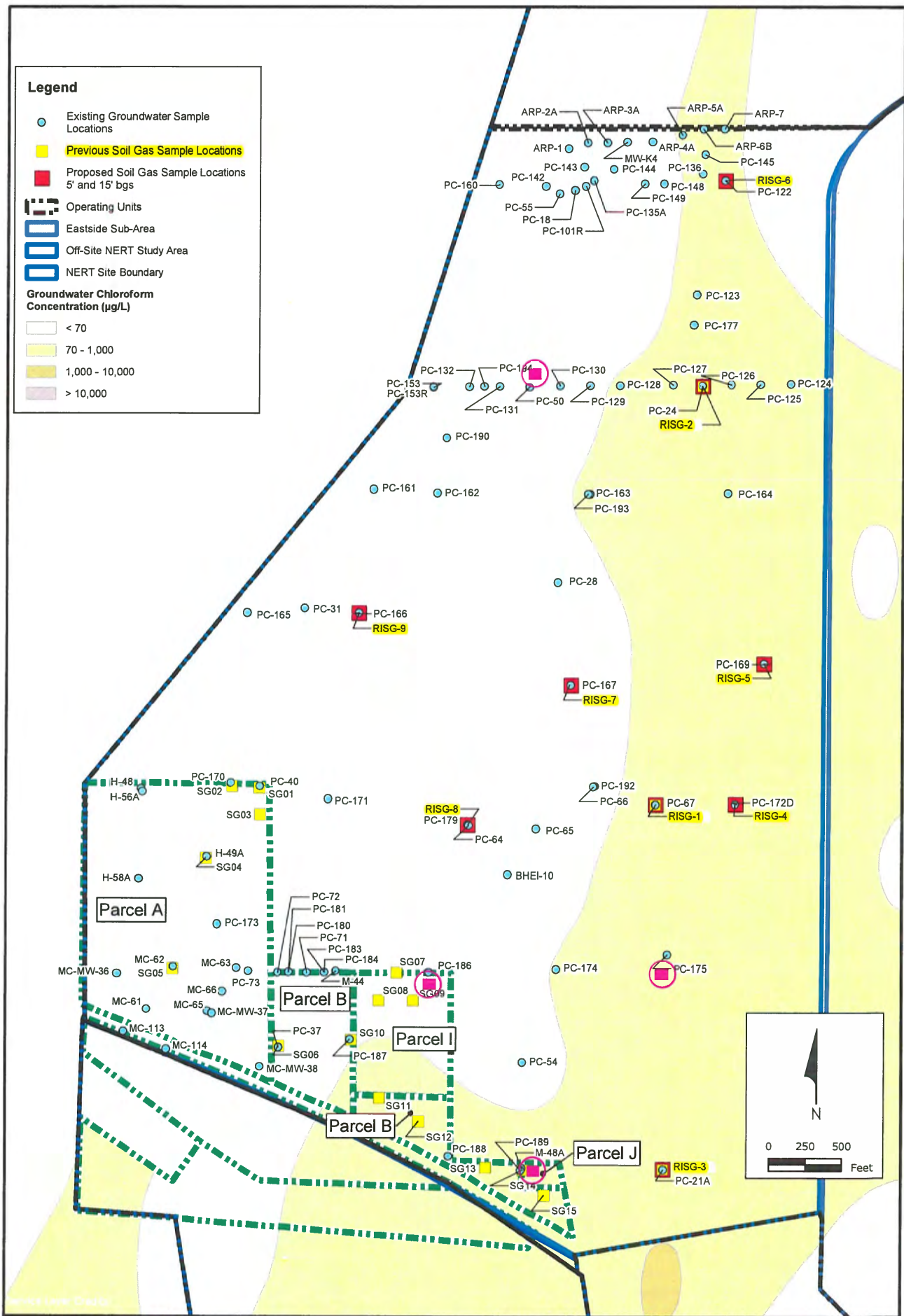

H:\LePetomane\NERT\Risk Assessment\Human Health\Offsite\_NERT\_Study Area\Mapa\ShallowGW\_SG\_OU2.mxd



**Proposed Soil Gas Sample Locations in the NERT Off-Site Study Area in OU-2 (Chloroform Plume as Depicted in 2017)**  
Nevada Environmental Response Trust Site, Henderson, Nevada

**Figure 2**